



# QDIS

**REWRITE THE STANDARD**

**QUICK  
INSTALLATION  
SYSTEM**



973-575-2600 1829 Underwood Blvd, Unit 5, Delran Twp, NJ 08075  
973-575-2603 [www.g2glighting.com](http://www.g2glighting.com)

# G2G QIS REWRITE THE STANDARD

G2G QIS, revolutionizing the LED industry with its new labor saving design.

## Specification

### A-1. Basic Info

<b>Model</b>	Single-End Female Connector	Double-End Female Connector
<b>Size</b>	0.787 x 0.894 x 0.425 (in)	0.756 x 1.433 x 0.453 (in)
<b>Wire</b>	18AWG/20AWG	18AWG

\*Female Connector is injected on wire.

<b>Model</b>	Double-End Male Connector	Double-End Male Connector
<b>Part No.</b>	QISA1001	QISA1002
<b>Size</b>	0.650 x 0.591 x 0.413 (in)	0.650 x 0.591 x 0.413 (in)
<b>Wire</b>	18 IN, 18AWG	4 FT, 18AWG

\*Connect Class 2 Power Supply to modules/stick by Male Connector with lead.

<b>Model</b>	Double-End Male Connector	Double-End Male Connector
<b>Part No.</b>	QISA4001	QISA4002
<b>Size</b>	0.650 x 0.591 x 0.413 (in)	0.650 x 0.591 x 0.413 (in)
<b>Wire</b>	7FT, 18AWG	10FT, 16AWG

\*Connect Class 2 Power Supply to modules/stick by Male Connector with lead.

<b>Model</b>	Single-End Male Connector	Single-End Male Connector
<b>Part No.</b>	QISA2001	QISA2002
<b>Size</b>	0.650 x 0.591 x 0.413 (in)	0.650 x 0.591 x 0.413 (in)
<b>Wire</b>	7FT, 18AWG	10FT, 16AWG

\*Connect Class 2 Power Supply to modules/stick by Male Connector with lead.

<b>Model</b>	Power Distribution Connector(PDC)	<b>Model</b>	Power Supply
<b>Part No.</b>	QISA3001	<b>Part No.</b>	QIS PS1001(60W, 12V)
<b>Size</b>	2.421 x 1.433 x 0.398 (in)		QIS PS1002(120W, 24V)
<b>MAX Input</b>	60W, 12V or 96W, 24V		QIS PS2001(100W, 24V)
<b>MAX Output</b>	60W, 12V or 96W, 24V	<b>Size</b>	See Page10

\*Connect Class 2 Power Supply to Power Distribution Connector (PDC) and connect modules/sticks to PDC.

IP67  **PATENT PENDING**

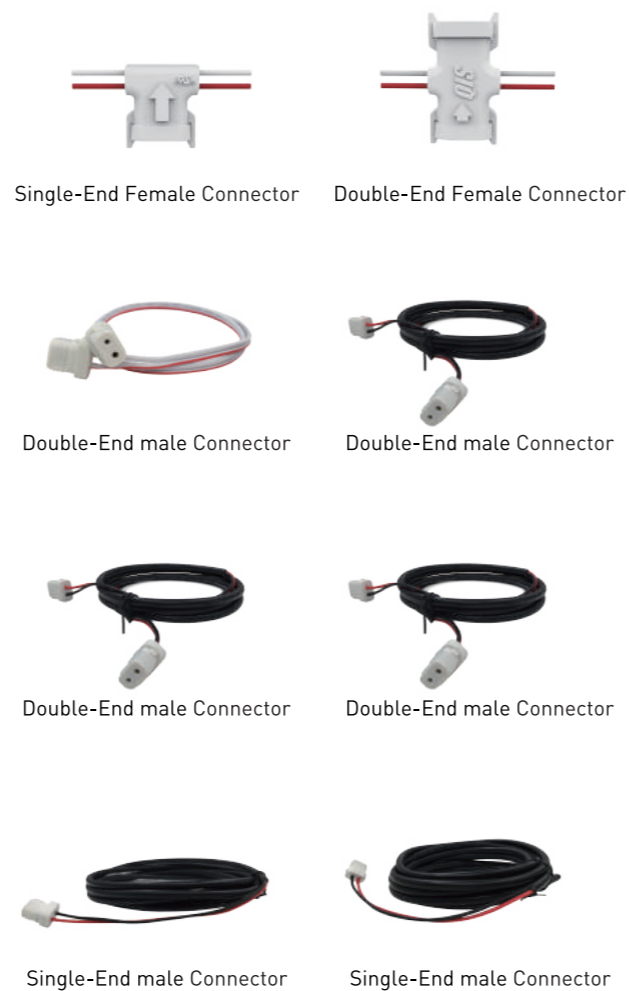

Single-End Female Connector Double-End Female Connector

Double-End male Connector Double-End male Connector

Double-End male Connector Double-End male Connector

Single-End male Connector Single-End male Connector

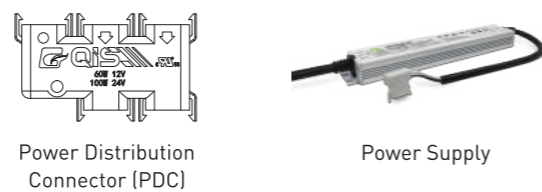

Power Distribution Connector (PDC) Power Supply

## Drawing

### Single-End Female Connector

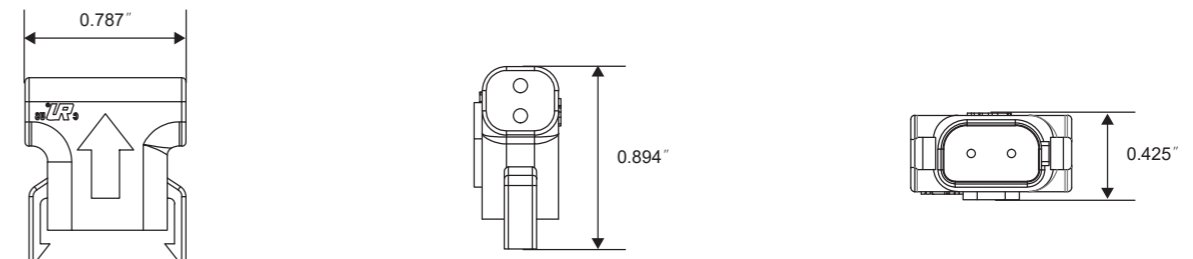

### Double-End Female Connector

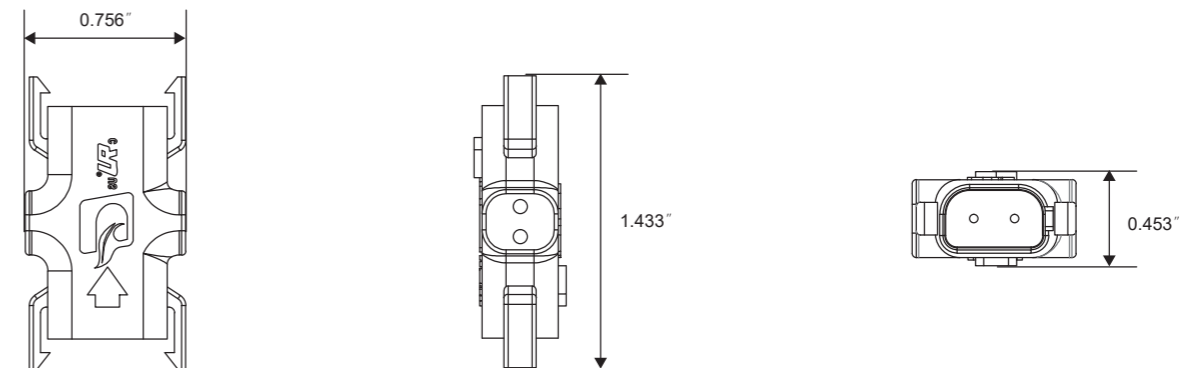

### Male Connector

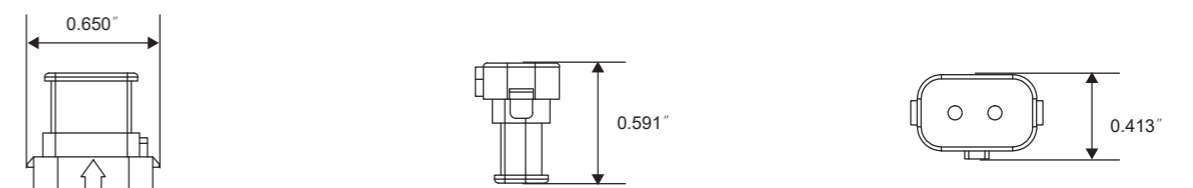

### Power Distribution Connector (PDC)

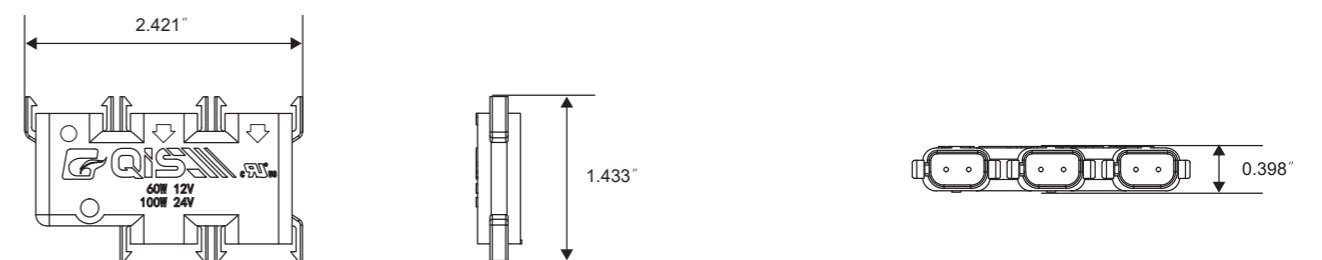

## A-2. Detail Info

### EX. QIS WOW II Drawing

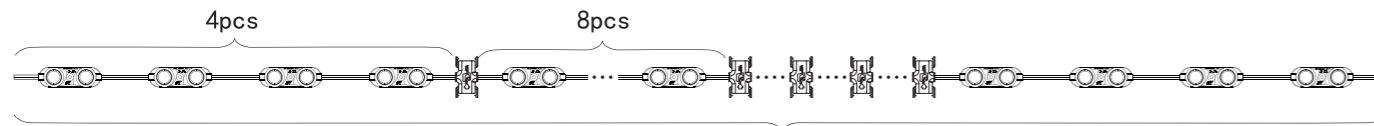

Modules	First Connector is after	Connector Spacing	Single-End/Double-End Female Connector
Little Giant	2nd module	4 modules	Single-End
Yo	5th module	10 modules	Single-End
WOW Series	3rd module	6 modules	Single-End
WOW II Series	4th module	8 modules	Double-End
Anpro 180 Series	4th module	8 modules	Double-End
Anpro 180 Plus Series	4th module	8 modules	Double-End
Anpro 160 Series	4th module	8 modules	Double-End
Trident DF 160	2nd module	8 modules	Single-End
Trident SF 160/180	2nd module	8 modules	Single-End
Enterprise	2nd module	2 modules	Single-End
Anpro180 SF/DF Stick	/	Middle of stick	Double-End
Anpro 180 Plus SF/DF Stick	/	Middle of stick	Double-End
RGB	Before 1st module	8 modules	Single-End
RGBW	Before 1st module	10 modules	Single-End
Flex/Flex Mini	/	Each Unit	Double-End
G2G Edge	/	Each Unit	Single-End&Double-End

\*Based on the application, different modules have a varying number of single-end female or double-end female connectors.

## QIS Overview

Quick Installation System(QIS) comes as a plug and play system. Proprietary pre-wired female connectors found on module chain accept G2G's male connector utilizing water tight rubber seals to seamlessly secure your connection. No wire nuts needed. (IP rating: IP67)

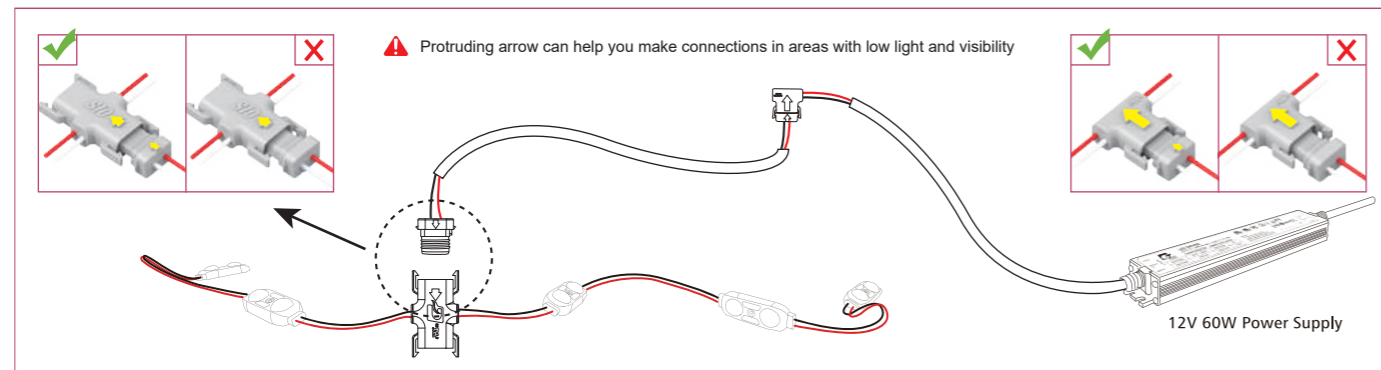

## B-1. LED Module Installation Overview (Single-end Female Connector)

Option1:

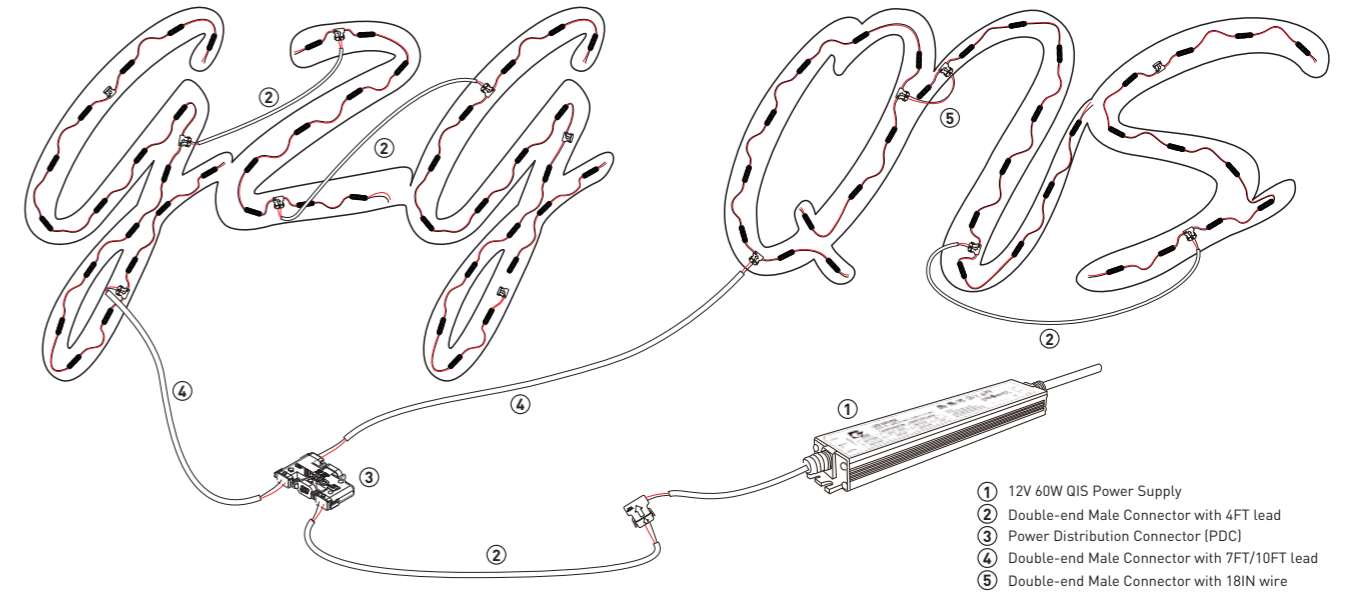

1. Install QIS modules inside of the channel letter.
2. Insert the double end male connector into a female connector found on the module chain.
3. Wire 7/10ft Jacketed Cable to Power Distribution Connector and connect the power supply in the same fashion.

## B-2. LED Module Installation Overview (Double-end Female Connector)

Option2:

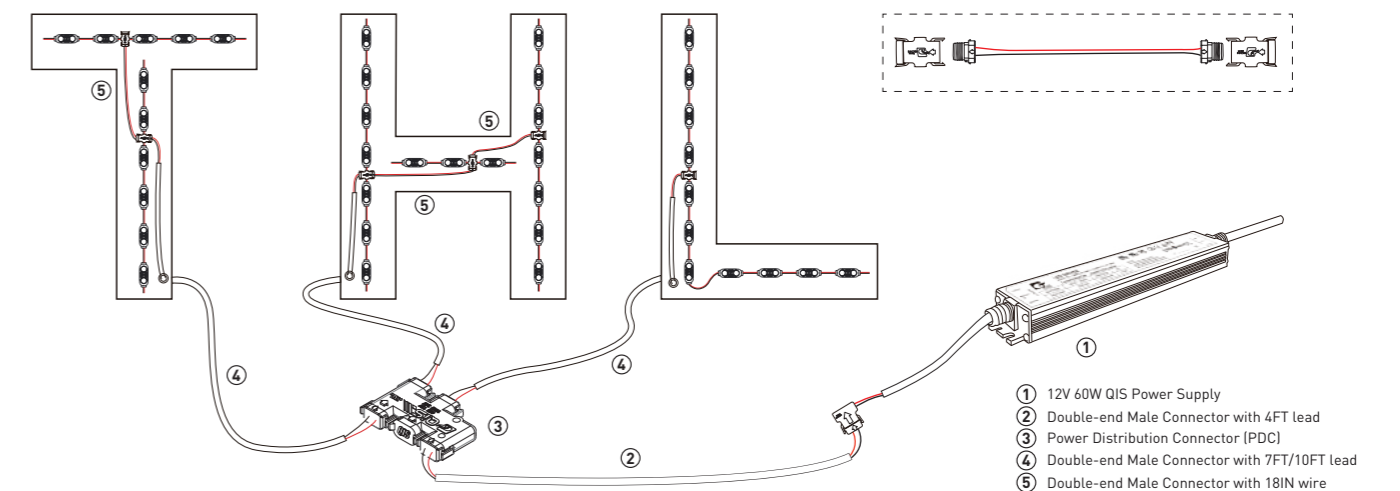

1. Install QIS modules inside of the channel letter.
2. Insert the double end male connector into a centrally located female connector found on the module chain.
3. Wire 7/10ft Jacketed Cable to Power Distribution Connector and connect the power supply in the same fashion.

### B-1. LED Stick Application in Small Sign Cabinet

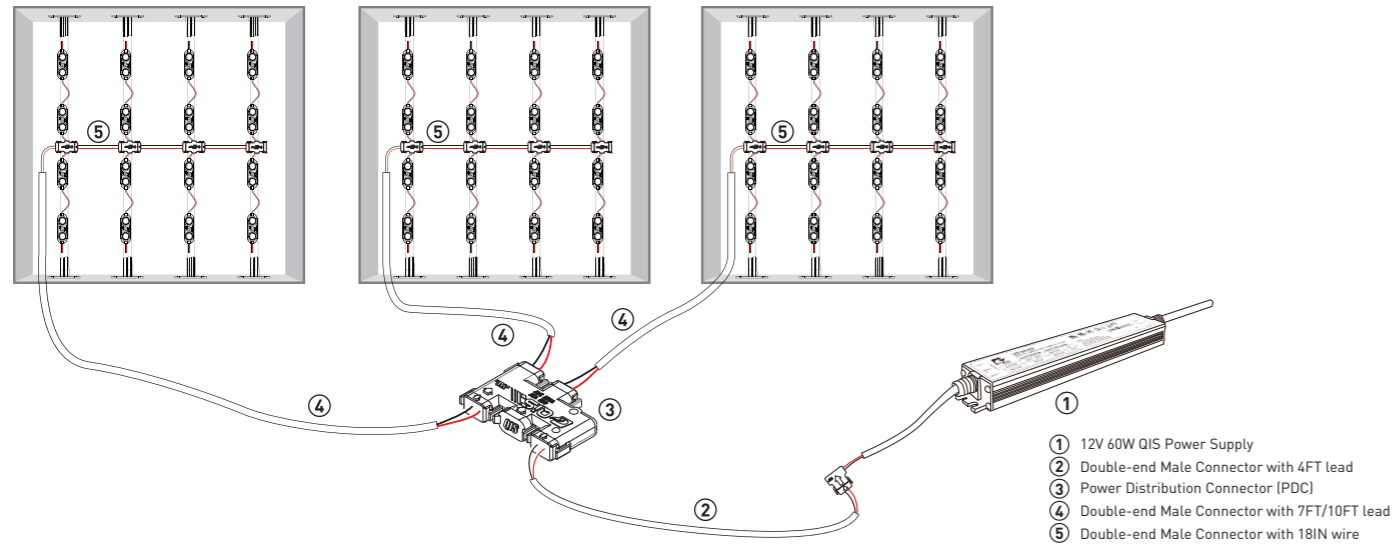

1. Use the 18" double-end male connector to connect each stick together as shown above.
2. Use Double-end male connector connect sticks to the Power Distribution Connector.
3. Use appropriate length Double-end male connector to connect G2G power supply to PDC.

### B-2. LED Stick Application in Big Sign Cabinet

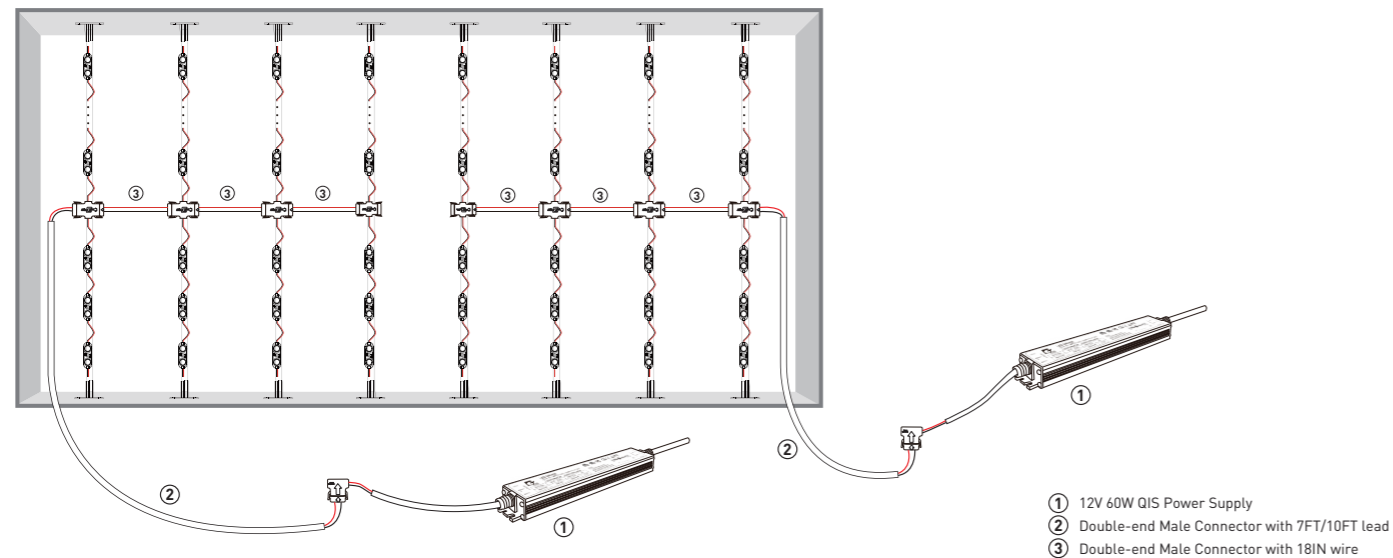

1. Install the QIS sticks inside the cabinet.
2. Use Double-end male connector with 18in wire to connect each stick.
3. Use appropriate length Double-end connector to connect power supply to stick.

### C-1. RGB Module Installation Overview

Option1:

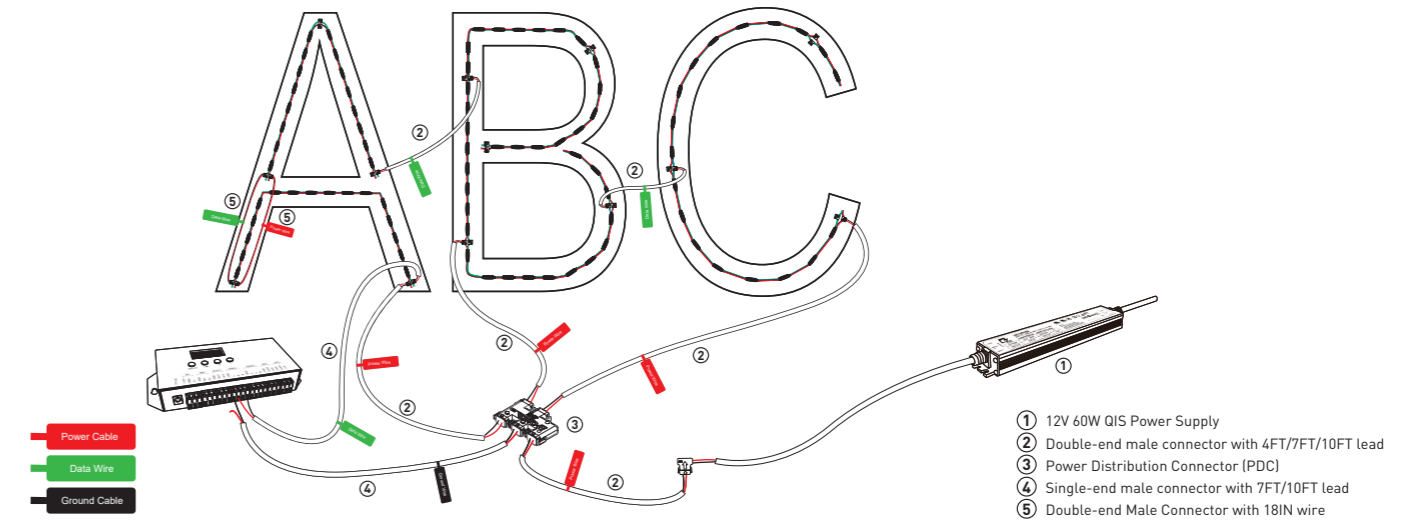

1. Install the RGB modules in the channel letter following the G2G layout and connect power like G2G QIS White Modules.
2. Connect Single-end male connector to controller, connect and daisy chain the modules as shown in the wiring diagram.
3. Using a single-end male connector, connect to the first PDC connector for power. Connect the bare black wire to the port, as indicated in the wiring diagram. Terminate the red wire.

*\*Must daisy chain PDCs if more than one power supply is used, follow the wiring diagram on layout.*

Option2:

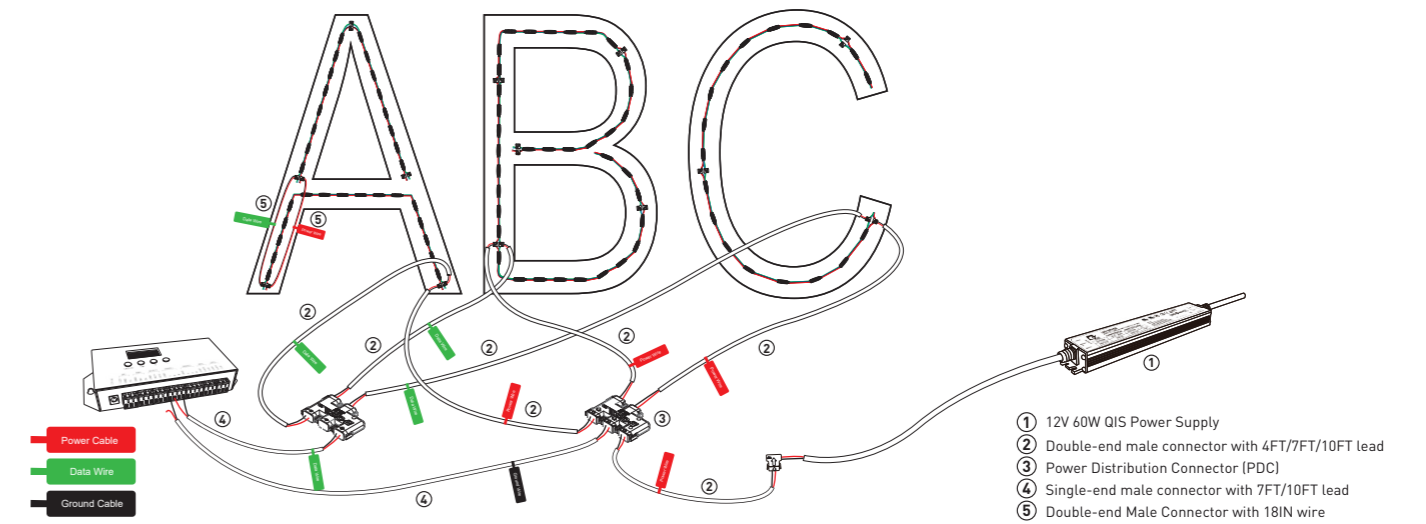

1. Install the RGB modules in the channel letter following G2G layout and connect up power like G2G QIS White modules.
2. Using the double end male connector, connect to the data female port. Connect the other end to a PDC dedicated to data.
3. Using a single end male connector, connect from the PDC connector. Connect the bare wires to the port on the controller, as instructed in wiring diagram.
4. Using a single male connector, connect to the first PDC connector for power. Connect the bare black wire to the port, as indicated in wiring diagram. Terminate the red wire.

*\*Must daisy chain PDCs if more than one power supply is used, follow the wiring diagram on layout.*

### C-2. Aurora Flex Installation Overview

Option1:

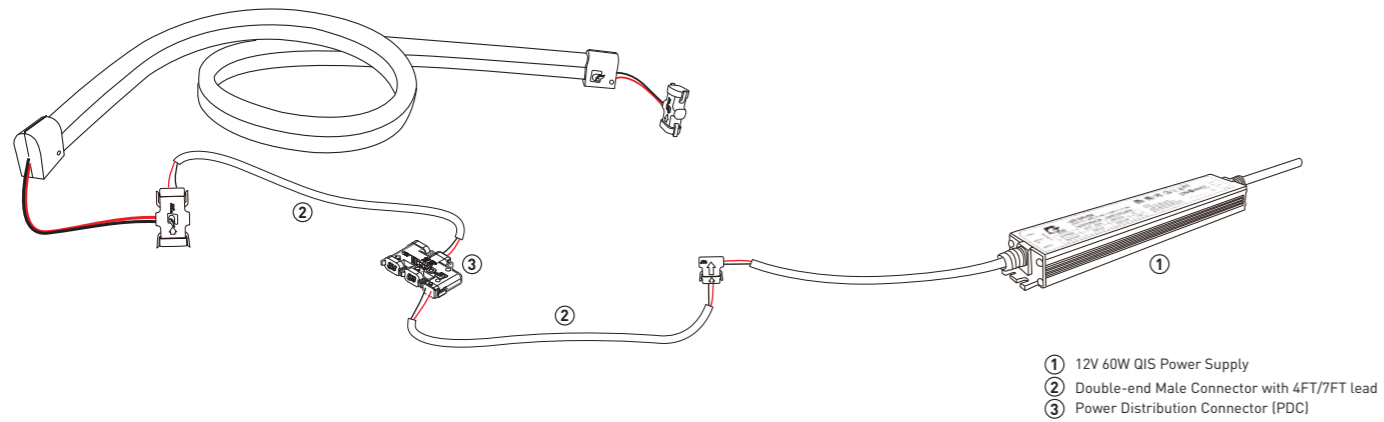

1. Following the G2G layout, install the Aurora Flex Series product.
2. Connect double end male connect to the power end of the Aurora Flex. Connect other end to a PDC.
3. Connect a double end male connector to the PDC and power supply.
4. Repeat steps for 1 and 2 for additional pieces of flex. (Remember to follow proper power supply loading guidelines.)

Option2:

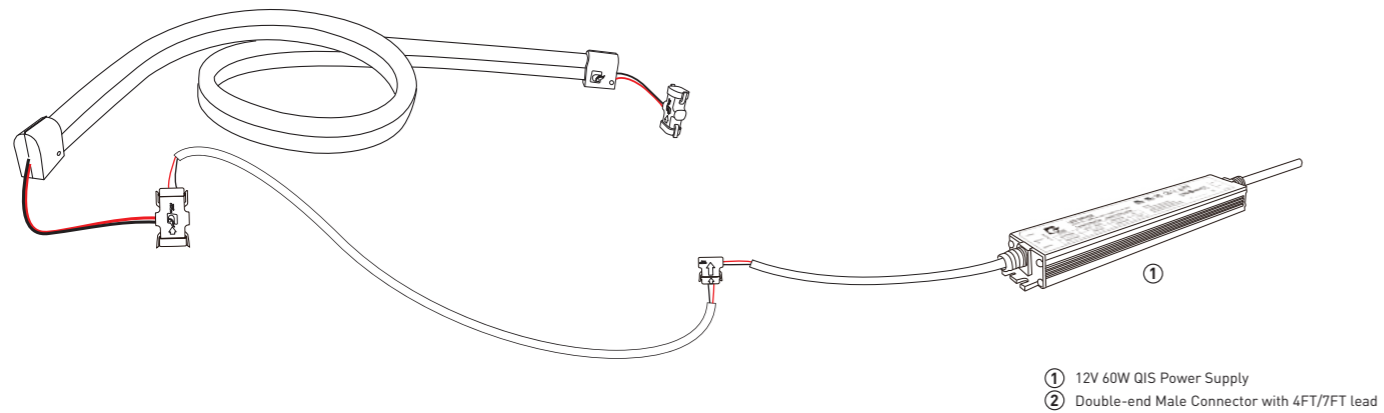

1. Following the G2G layout, install the Aurora Flex Series product.
2. If at full load connect directly to the power supply.

### C-3. G2G Edge RGB Installation Overview

Option1:

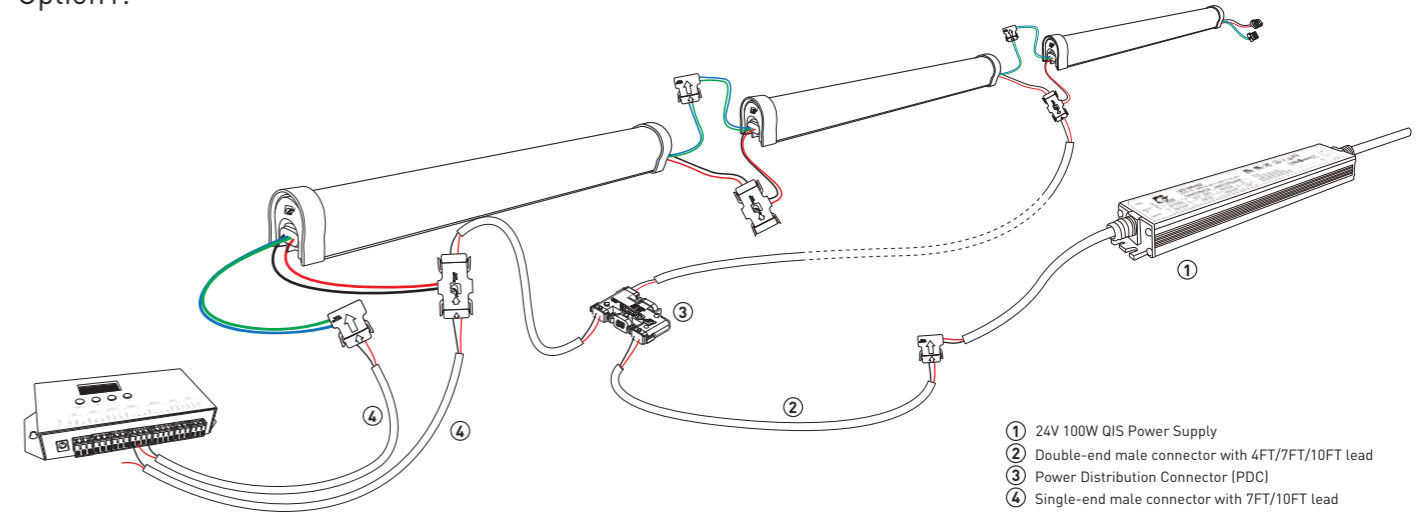

1. Following the layout, install G2G Edge.
2. Connect power supply to PDC using double end male connector.
3. Connect PDC to power end of the Edge using a double end male connector.
4. Connect single end male connector to the controller for data to the port as instructed on the layout. Connect male connector to the data connector on the edge.
5. Connect single-end male connector to the power PDC and run the black wire back to the controller. Must daisy chain the PDC for negative. Follow layout.

Option2:

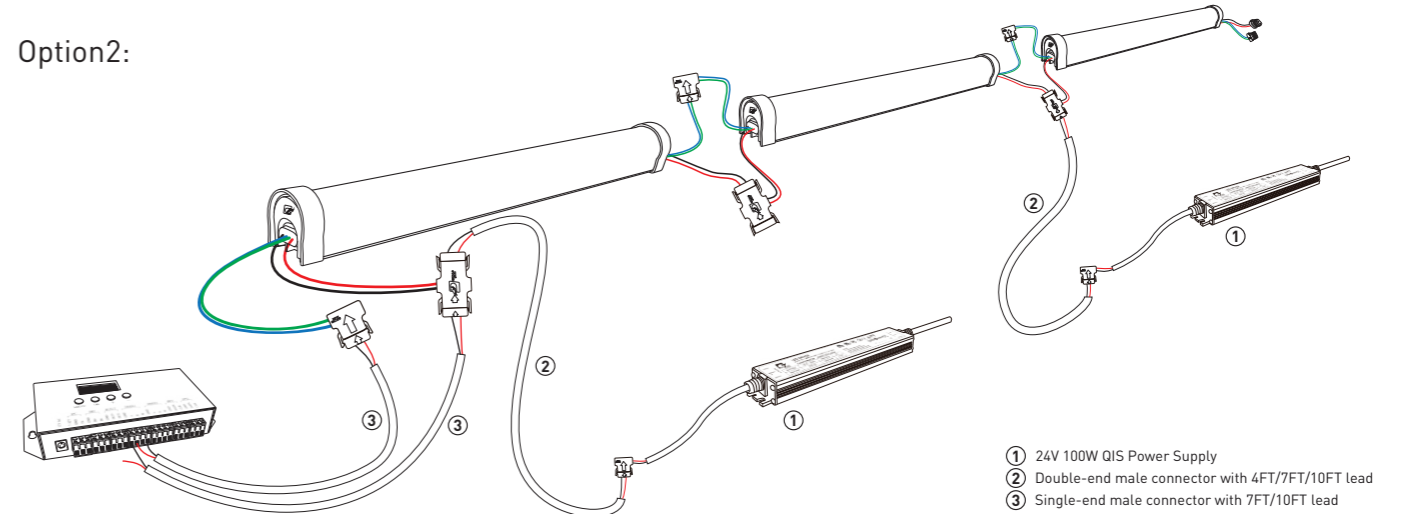

1. Following the layout, install G2G Edge.
2. Connect the power supply to the power end of the G2G Edge using a double end connector.
3. IF RGB, connect single-end male connector to the controller for data to the port as instructed on the layout. Connect male connector to the data connector on the Edge.
4. Connect a Single male connector to the power end of edge and run the black wire back to the controller. Follow the layout.

### C-3. G2G Edge Installation Overview

Option1:

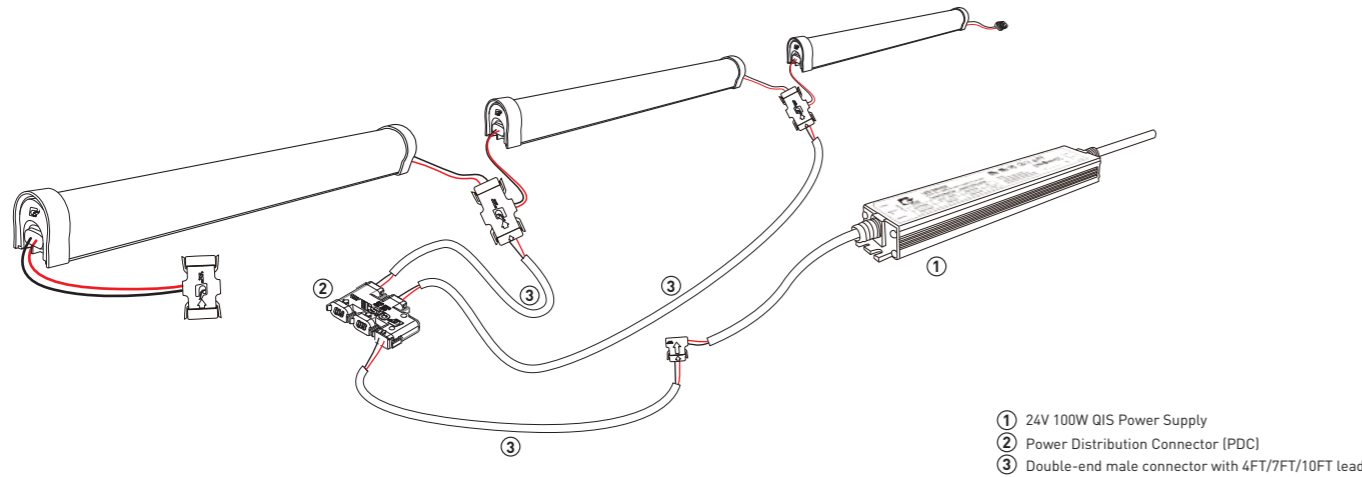

1. Following the layout, install G2G Edge.
2. Connect the power supply to the power end of the G2G Edge to the PDC using a double end male connector.  
Repeat as many pieces as necessary. Make sure to follow proper loading guides.
3. Repeat with each power supply as necessary.

Option2:

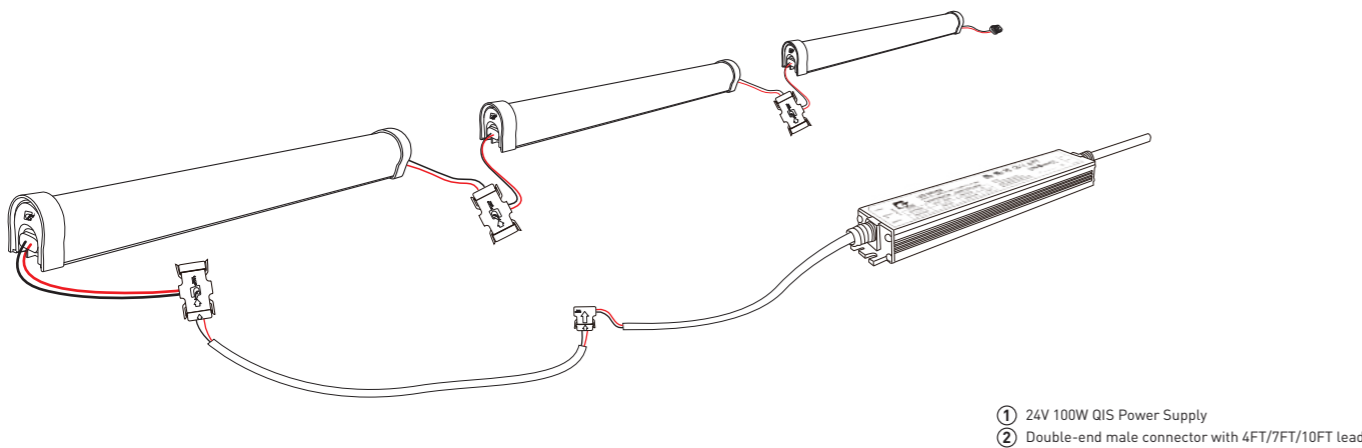

1. Following the layout, install G2G Edge.
2. Connect power end of the G2G end to the power supply. Using our the male connector on the opposite end, daisy chain as many pieces required. (Make sure to follow proper loading guidelines).
3. Repeat with each power supply as necessary.

### POWER SUPPLY

#### Feature

- 100-277VAC Input
- 12VDC and 24VDC Outputs available
- -25 to 50°C operating temperature
- UL/cUL Recognized
- Packaging: 10pcs/box
- Warranty: 5 Years



#### Specification

Items	Dimensions	Nominal Input Voltage	Max. Output Current	Power Output	Operating Temperature
G2G-QISM-60W-12VDC	7.99in x 1.38in x 0.79in	100-277 VAC, 50-60Hz	5 A	60W 12VDC, Class 2 output	-25° C to + 50° C
G2G-QISM-100W-24VDC	10.08in x 1.77in x 0.91in	100-277 VAC, 50-60Hz	4 A	100W 24VDC, Class 2 output	-25° C to + 50° C
G2G-QISM-120W-12VDC	10.08in x 1.77in x 0.91in	100-277 VAC, 50-60Hz	5 A*2	120W 12VDC, Class 2 output	-25° C to + 50° C

### PACKING

Modules	Box	Case
Little Giant	60pcs/chain, 60pcs/bag	10bags
Yo	80pcs/chain, 80pcs/bag	10bags
WOW Series	60pcs/chain, 60pcs/bag	10bags
WOW II Series	40pcs/chain, 80pcs/bag	10bags
Anpro 180 Series	40pcs/chain, 80pcs/bag	10bags
Anpro 180 Plus Series	40pcs/chain, 80pcs/bag	10bags
Anpro 160 Series	40pcs/chain, 80pcs/bag	10bags
Trident DF 160	20pcs/chain, 20pcs/bag	10bags
Trident SF 160 / 180	20pcs/chain, 20pcs/bag	10bags
Enterprisse	8pcs/chain, 8pcs/bag	12bags
Anpro180 SF/DF Stick	6pcs	12pcs
Anpro 180 Plus SF/DF Stick	6pcs	12pcs
Trident SF 180 Stick	6pcs	12pcs
Trident DF 160 Stick	6pcs	12pcs
RGB	40pcs/chain, 80pcs/bag	10bags
RGBW	20pcs/chain, 20pcs/bag	10bags

Accessories	Box	Case
Double-end Male Connector 18in Wire (18AWG)	100pcs	600pcs
Double-end Male Connector 4ft Jacketed Cable (18AWG)	20pcs	120pcs
Double-end Male Connector 7ft Jacketed Cable (18AWG)	20pcs	120pcs
Double-end Male Connector 10ft Jacketed Cable (16AWG)	10pcs	60pcs
Single-end Male Connector 7ft Jacketed Cable (18AWG)	20pcs	120pcs
Single-end Male Connector 10ft Jacketed Cable (16AWG)	10pcs	60pcs
Power Distribution Connector (PDC)	20pcs	

